

NATIONAL
PREA
RESOURCE
CENTER



NCCD | National Council on
Crime & Delinquency

Understanding LGBTI Inmates and Residents

December 9, 2014

Notice of Federal Funding and Federal Disclaimer – This project was supported by Grant No. 2010-RP-BX-K001 awarded by the Bureau of Justice Assistance. The Bureau of Justice Assistance is a component of the Office of Justice Programs, which also includes the Bureau of Justice Statistics, the National Institute of Justice, the Office of Juvenile Justice and Delinquency Prevention, the Office for Victims of Crime, and the Office of Sex Offender Sentencing, Monitoring, Apprehending, Registering, and Tracking. Points of view or opinions in this document are those of the author and do not necessarily represent the official position or policies of the U.S. Department of Justice.

Logistics

Webinar Information

- Use the question box to ask a question, or email Tara Graham at tgraham@nccdglobal.org
- If you have technology issues, call Tara Graham at (510) 874-5921.

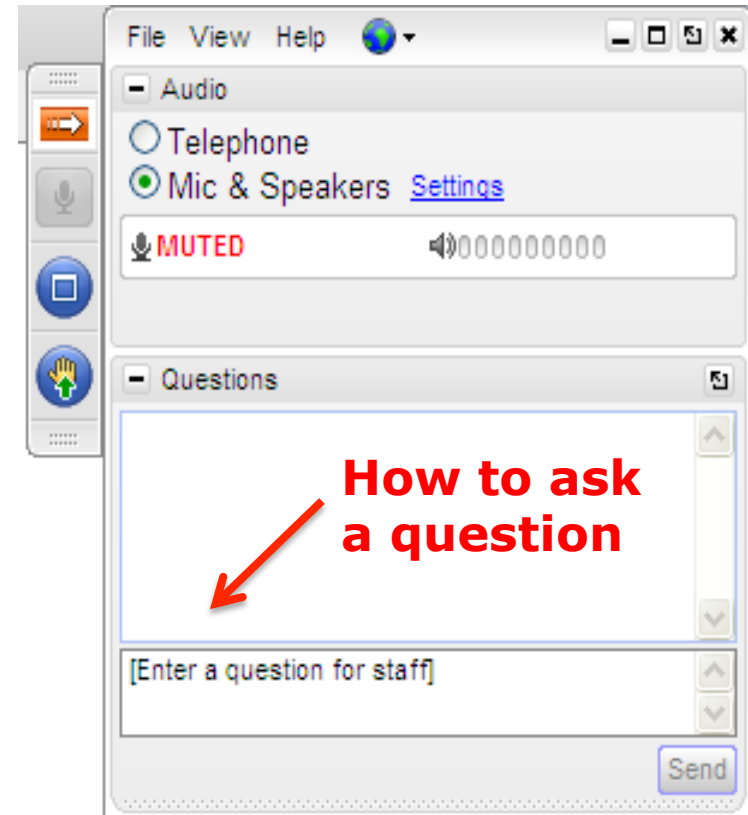

Understanding LGBTI Inmates and Residents

Agenda

Welcome From PREA Management Office

Terminology

Research and Background Information

LGBTI PREA Standards

Effective Communication Tips

Q and A



Welcome PREA Management Office

NATIONAL
PREA
RESOURCE
CENTER

Understanding LGBTI Inmates and Residents

Terminology

SOGIE: Sexual orientation, gender identity, and/or gender expression.

Sexual orientation is about who you are emotionally, sexually, or romantically attracted to, whether you are lesbian, gay, bisexual, straight, asexual, or other.

Which are different from ...

Gender identity refers to how a person understands their own gender (man, woman, other).

Gender expression is about how a person expresses their gender identity through their manner of dress, speech, behavior, and/or other physical expressions (masculine, feminine, androgynous, other).

Understanding LGBTI Inmates and Residents

Lesbian: A woman who is emotionally, romantically, and sexually attracted to other women.

Gay: A man who is emotionally, romantically, and sexually attracted to other men.

Bisexual: A man or woman who is emotionally, romantically, and sexually attracted to both men and women.

Straight: A person who is emotionally, romantically and sexually attracted to another person who is of a different sex and/or gender.

Asexual: A person who is not sexually attracted to any sex and/or gender.

Understanding LGBTI Inmates and Residents

Gender conforming means a person whose appearance or manner conforms to traditional societal gender expectations (e.g., a person who was designated female at birth, identifies as a girl/woman, and dresses in a way that society determines a girl/woman should dress).

Gender nonconforming (GNC) means a person whose appearance or manner does not conform to traditional societal gender expectations (e.g., someone who identifies as a girl/woman but wears clothing typically assigned to boys/men).

Understanding LGBTI Inmates and Residents

Transgender means a person whose gender identity (i.e., internal sense of feeling male or female) is different from the person's assigned sex at birth.

Note: "Gender Identity Disorder" was replaced with "Gender Dysphoria" in the Diagnostic and Statistical Manual (DSM-5).

Cisgender means a person whose gender identity is the same as their sex assigned at birth.

Which are different from ...

Intersex means a person whose sexual or reproductive anatomy or chromosomal pattern does not seem to fit typical definitions of male or female. Intersex medical conditions are sometimes referred to as disorders of sex development.

Note: Approximately 1 in every 1,500 to 2,000 people are born intersex.

Understanding LGBTI Inmates and Residents

Intersex

Type	Chromosomes	Sex Assigned at Birth	Gender Identity
Androgen Insensitivity Syndrome	46 XY	C: Female P: Male or female	C: Woman P: Woman or man

Understanding LGBTI Inmates and Residents

Transgender and Gender Nonconformity

Birth Certificate	Gender Identity	Gender Expression	Transgender?	Gender Nonconforming?
1) Male	Man	Masculine	No	No
2) Male	Man	Feminine	No	Yes
3) Male	Woman	Feminine	Yes, woman (transwoman)	No
4) Female	Woman	Feminine	No	No
5) Female	Woman	Masculine	No	Yes
6) Female	Man	Masculine	Yes, man (transman)	No

Understanding LGBTI Inmates and Residents

Question 1

Sexual orientation is about emotional, sexual, and/or romantic attraction.

- a) True
- b) False

Understanding LGBTI Inmates and Residents

Answer 1

a) True

Understanding LGBTI Inmates and Residents

Question 2

A person whose appearance or manner does **not** conform to traditional societal gender expectations (e.g., someone who identifies as a girl/woman but wears clothing typically assigned to boys/men) is considered to be:

- a) Gay
- b) Gender nonconforming
- c) Neither (a) nor (b)
- d) Both (a) and (b)

Understanding LGBTI Inmates and Residents

Answer 2

b) Gender nonconforming

Understanding LGBTI Inmates and Residents

Question 3

Think about the issues that comprise the LGBT movement. Which issue do you hear about the most?

- a) The right to marry for gay and lesbian couples
- b) Criminal profiling and incarceration of LGBT people
- c) The right to serve openly in the military for LGBT people
- d) Bullying in schools with respect to LGBT youth
- e) Homelessness with respect to LGBT youth

Understanding LGBTI Inmates and Residents

Stonewall and the Beginning of the LGBT Movement



Understanding LGBTI Inmates and Residents

Question 4

Approximately what percentage of the adult population is lesbian, gay, or bisexual (LGB)?

- a) 4%
- b) 7%
- c) 10%

Understanding LGBTI Inmates and Residents

Bureau of Justice Statistics, 2013
Williams Institute, 2011

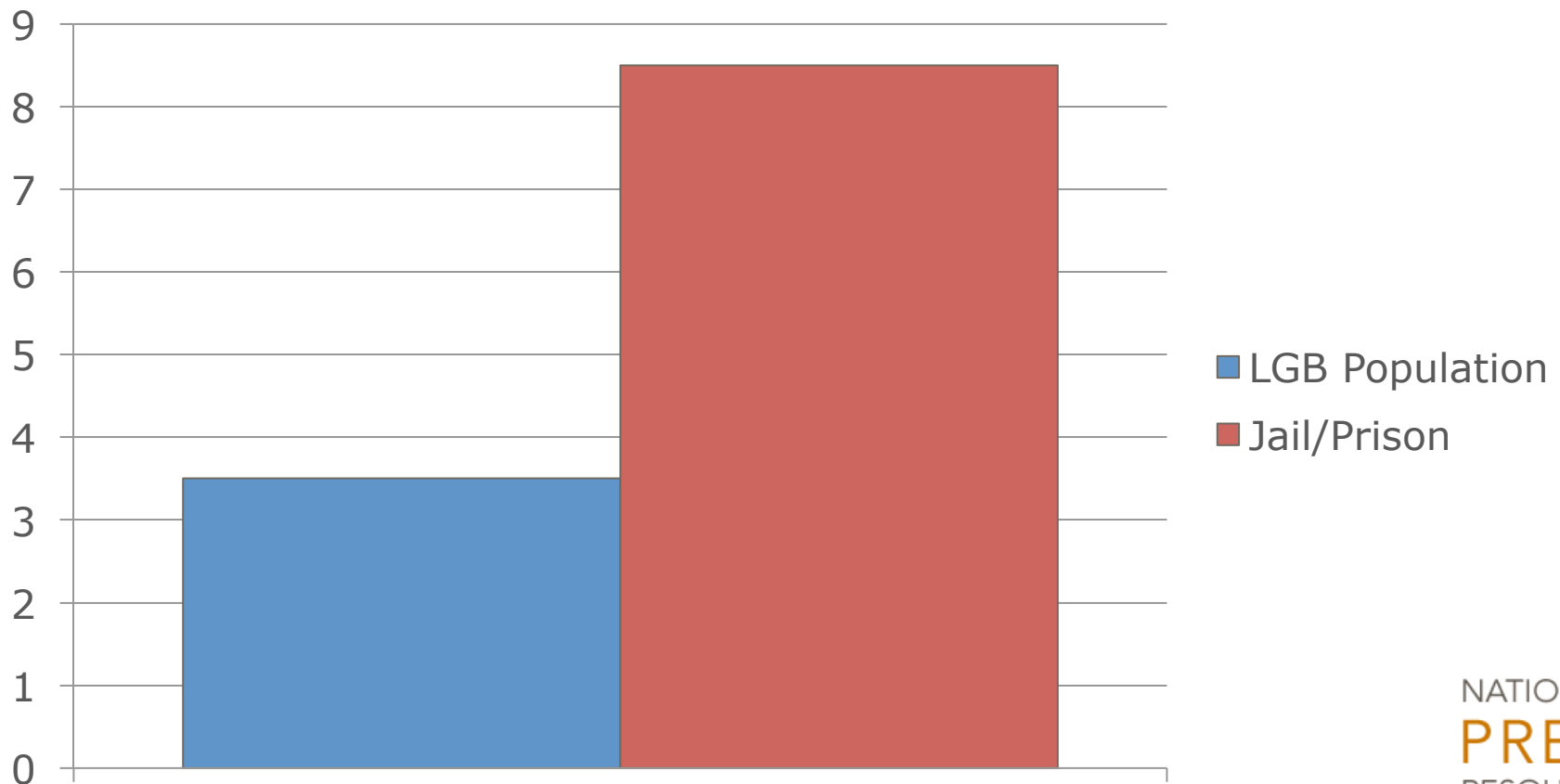

Understanding LGBTI Inmates and Residents

Bureau of Justice Statistics, 2013

Sexual Victimization

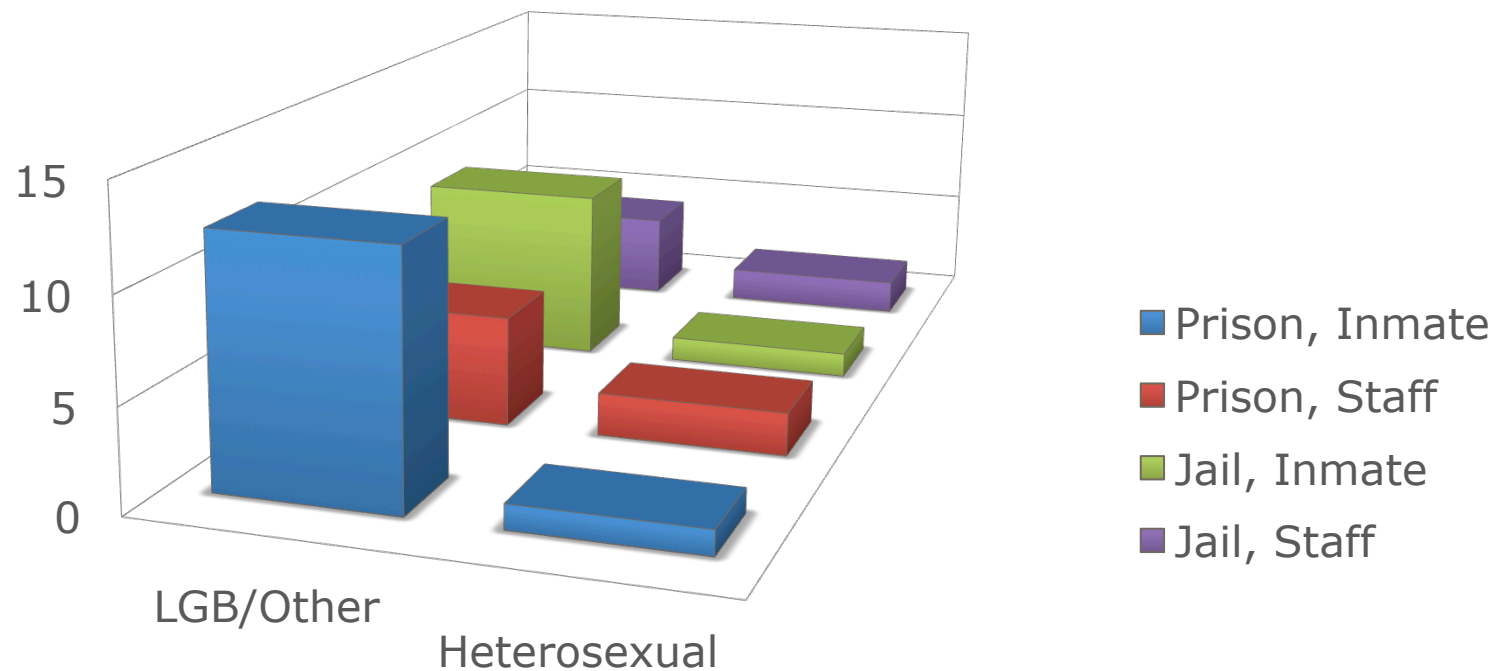

Understanding LGBTI Inmates and Residents

Question 5

Approximately what percentage of the adult population is transgender?

- a) Less than 1%
- b) 2%
- c) 3%

Understanding LGBTI Inmates and Residents

Williams Institute, 2011
National Transgender Discrimination Survey, 2011

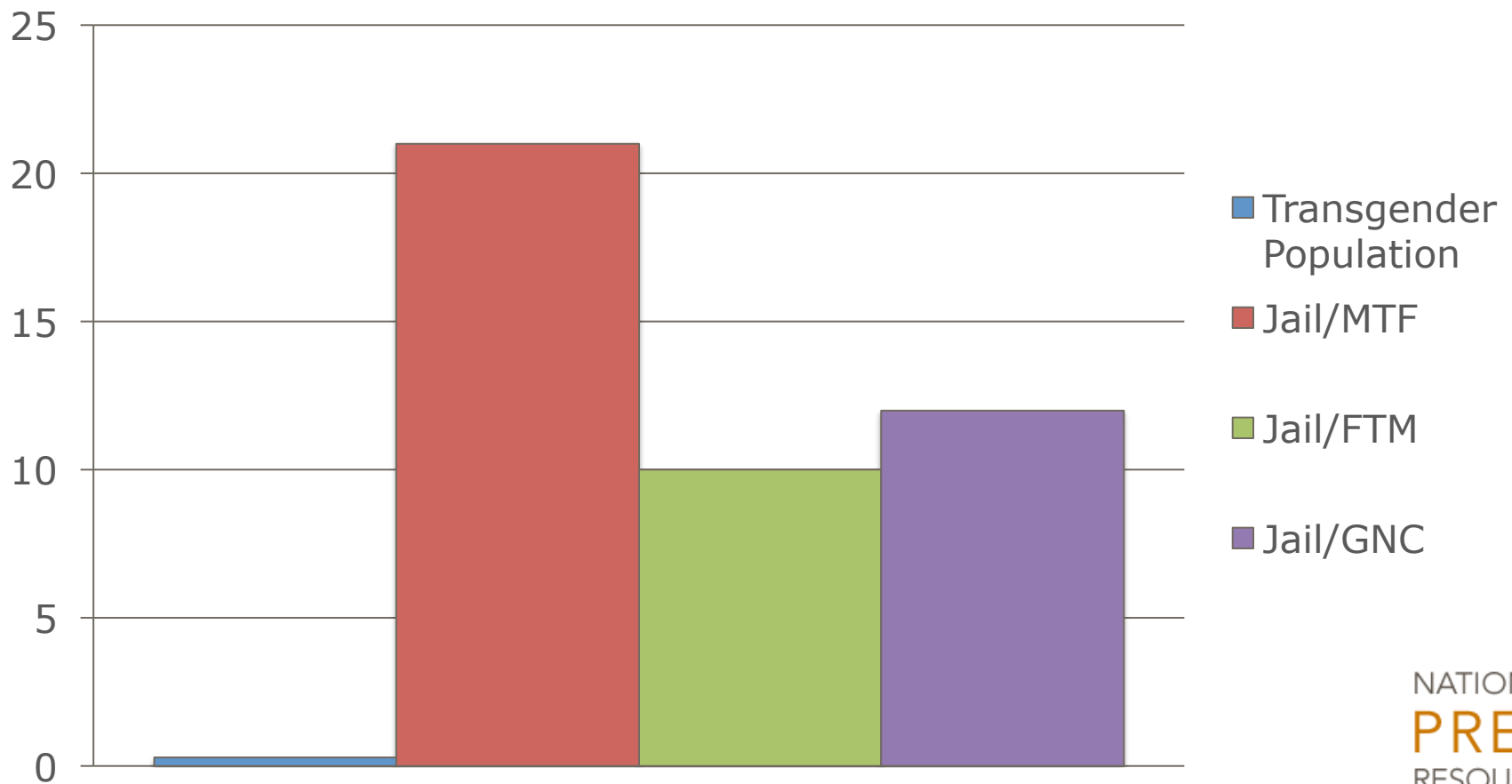

Understanding LGBTI Inmates and Residents

National Transgender Discrimination Survey, 2011

Sexual Assault by Anyone

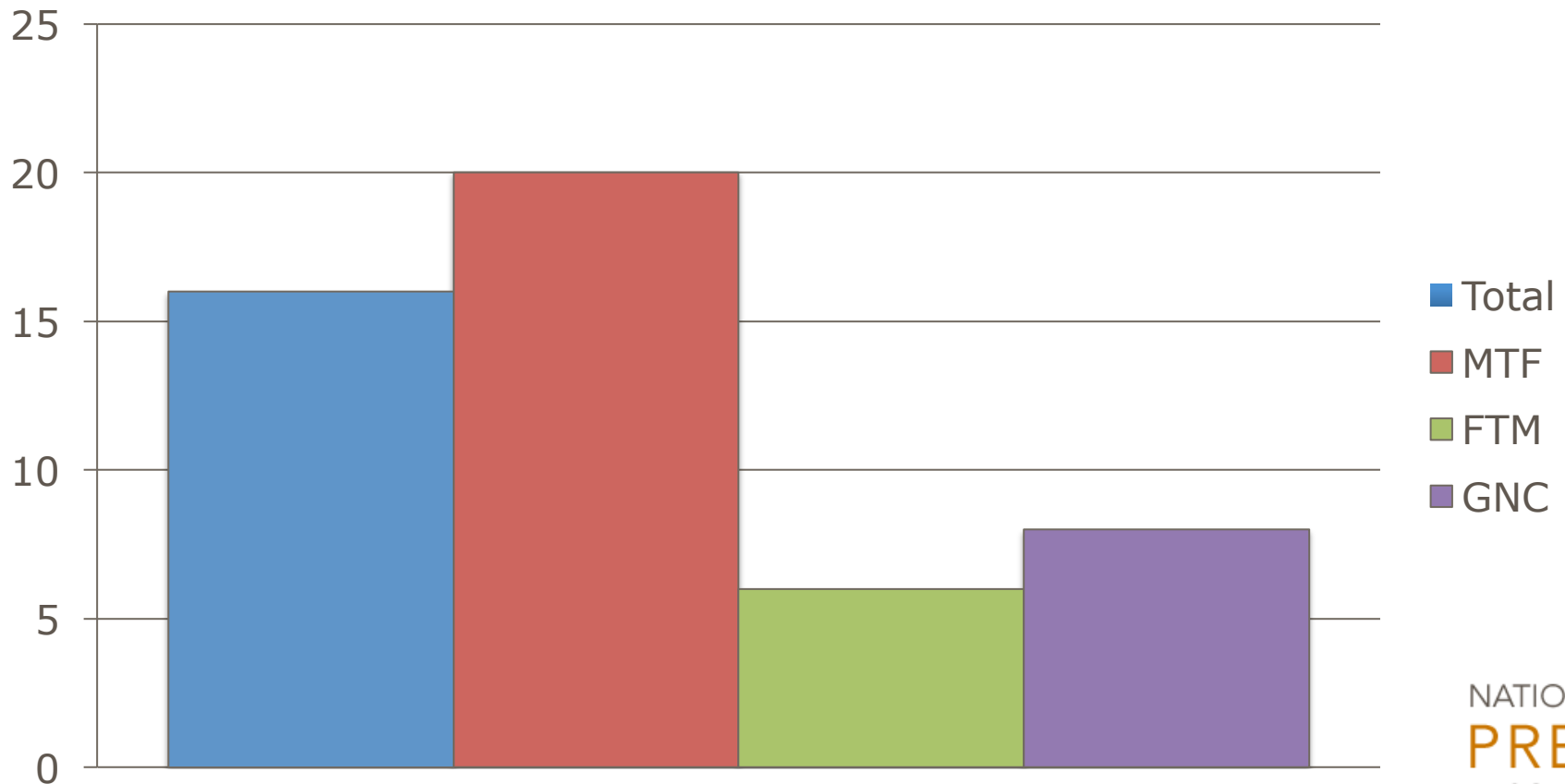

Understanding LGBTI Inmates and Residents

Question 6

About what percentage of the youth population is lesbian, gay, or bisexual?

- a) 7%
- b) 10%
- c) 12%

Understanding LGBTI Inmates and Residents

LGBQ and GNC Youth in Detention

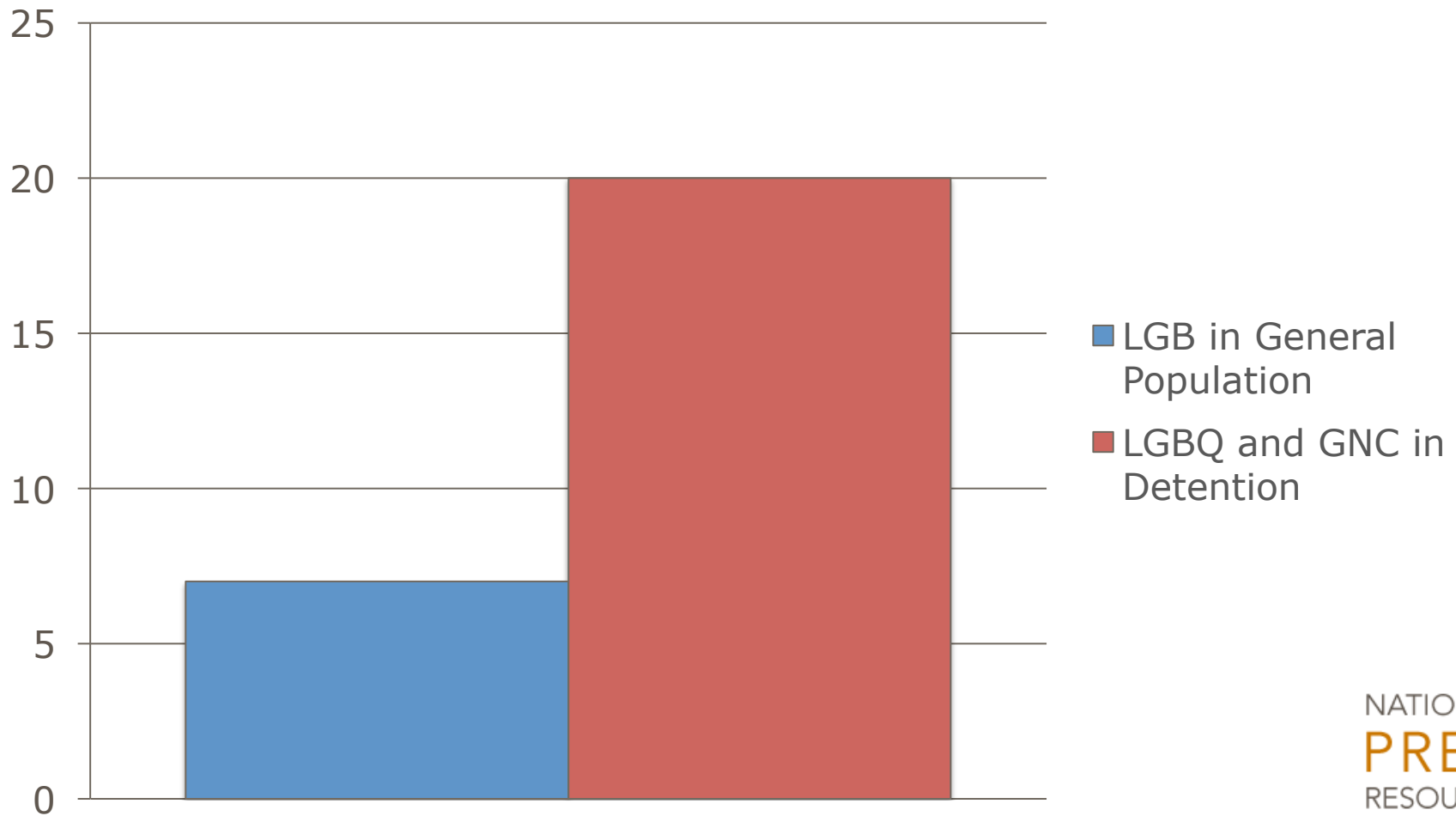

Understanding LGBTI Inmates and Residents

Sexual Orientation and Gender Conformity, Girls

	Heterosexual	LBQ
Gender Conforming	60.1%	22.9%
Gender Nonconforming	7.8%	9.2%

Understanding LGBTI Inmates and Residents

Sexual Orientation and Gender Conformity, Boys

	Heterosexual	GBQ
Gender Conforming	86.4%	3.5%
Gender Nonconforming	7.3%	2.8%

Understanding LGBTI Inmates and Residents

Question 7

Incarcerated LGB youth reported being sexually abused by other youth _____ than heterosexual youth.

- a) 3
- b) 7
- c) 10

Understanding LGBTI Inmates and Residents

Answer 7

- b) Seven times higher—youth with a sexual orientation other than heterosexual reported significantly higher rates of sexual victimization by other youth (10.3%) compared with heterosexual youth (1.5%).



Prison Rape Elimination Act Standards

PREA Standards: LGBTI Inmates and Residents

A Note on Perceptions

“Perceived” Status

Typically, “perceived” refers to how outsiders perceive another person’s sexual orientation, gender identity, or gender expression (SOGIE) and not how one perceives oneself.

PREA Standards: LGBTI Inmates and Residents

§ 115.31—Staff Training

- Requires training on effective and professional communication with lesbian, gay, bisexual, transgender, and intersex (LGBTI) and GNC inmates and residents.

Note: This standard does not apply to lockups.

§ 115.41—Screening for Risk of Sexual Victimization and Abusiveness

- § 115.41: Screening to determine if an inmate or resident is, or is perceived to be, LGBTI and/or GNC (language slightly different).

Note: This standard does not apply to lockups.

§ 115.86—Post-Incident Reviews

- § 115.86: Post-incident reviews—Consider whether incident was motivated by gender identity or LGBTI identification, status, or perceived status.

PREA Standards: LGBTI Inmates and Residents

§ 115.42—Use of Screening Information

- Prohibits placement of LGBTI inmates in dedicated facilities, units, or wings solely on the basis of such identification or status, unless such placement is in a dedicated facility, unit, or wing established in connection with a consent decree, legal settlement, or legal judgment for the purpose of protecting such inmates.

Note: This standard does not apply to lockups.

Unique to Juvenile Facilities

- § 115.342: Prohibits placement of LGBTI residents in particular housing, beds, or other assignments solely on the basis of their identification or status.
- § 115.342: LGBTI identification can NOT be used as a factor to predict sexual abuse.

PREA Standards: LGBTI Inmates and Residents

§115.15—Limits to Cross-Gender Viewing and Searches

- Prohibits searching or physically examining a transgender or intersex inmate or resident for the sole purpose of determining genital status.
- Security personnel must be trained in conducting professional and respectful cross-gender pat-down searches and searches of transgender and intersex inmates or residents.

Best practice: Allow transgender and intersex inmates and residents to choose the gender of the person to search them.

PREA Standards: LGBTI Inmates and Residents

§115.42—Use of Screening Information

- Facility, housing, and programming assignments for transgender and intersex inmates or residents shall be made on a case-by-case basis considering the following:
 - » Inmate or resident's health and safety;
 - » Management or security problems;
 - » Inmate's or resident's own view of their safety.
- Transgender and intersex inmates or residents must be given the opportunity to shower separately from other inmates or residents.

Note: This standard does not apply to lockups.

Understanding LGBTI Inmates and Residents

Communicating With LGBTI Inmates and Residents

- Self-management: Be mindful of your own beliefs, cultural norms, and gaps in knowledge surrounding SOGIE; pay attention to body language and facial expressions.
- Do not ask sexual abuse questions immediately before or after asking questions about SOGIE.*
- Do not make assumptions based on stereotypes; ask all inmates and residents the same questions.
- Avoid exclusively using “he, him, her, she,” pronouns until you have more information about the inmate/resident:
 - » “What is your preferred name and gender pronoun?”

*See Sexual Minority Assessment Research Team. (2009). *Best practices for asking questions about sexual orientation on surveys*. Retrieved from The Williams Institute website, <http://williamsinstitute.law.ucla.edu/wp-content/uploads/SMART-FINAL-Nov-2009.pdf>

Understanding LGBTI Inmates and Residents

Thank you!

What's on your mind?

For More Information

Visit the **National PREA Resource Center** at www.prearesourcecenter.org or direct questions to info@prearesourcecenter.org.

For audit assistance, please contact one of the following.

Scott Catey
Senior Program Specialist
scatey@nccdglobal.org

Marion Morgan
Senior Program Specialist
mmorgan@nccdglobal.org

Tara Graham
Senior Program Specialist
tgraham@nccdglobal.org

Sarah True
Program Associate
strue@nccdglobal.org

Please complete the following evaluation:
<https://www.surveymonkey.com/s/WZCT5T8>

Join us for a webinar on February 10, 2014 to learn about asking questions about sexual orientation during screening.
<https://www1.gotomeeting.com/register/290499816>

NATIONAL
PREA
RESOURCE
CENTER

Citations

- Beck, A. J., Berzofsky, M., Caspar, R., & Krebs, C. (2013). *Sexual victimization in prisons and jails reported by inmates, 2011–12*. Washington, DC: US Department of Justice, Office of Justice Programs, Bureau of Justice Statistics. Retrieved from <http://www.bjs.gov/content/pub/pdf/svpjri1112.pdf>
- Beck, A. J., Cantor, D., Hartge, J., & Smith, T. (2013). *Sexual victimization in juvenile facilities reported by youth, 2012*. Washington, DC: US Department of Justice, Office of Justice Programs, Bureau of Justice Statistics. Retrieved from <http://www.bjs.gov/content/pub/pdf/svjfry12.pdf>
- Gates, G. L. (2011). *How many people are lesbian, gay, bisexual and transgender?* Los Angeles, CA: UCLA School of Law, The Williams Institute. Retrieved from <http://williamsinstitute.law.ucla.edu/research/census-lgbt-demographics-studies/how-many-people-are-lesbian-gay-bisexual-and-transgender/>
- Grant, J. M., Mottet, L. A., Tanis, J., Harrison, J., Herman, J., & Keisling, M. (2011). *Injustice at every turn: a report of the national transgender discrimination study*. Washington, DC: National Center for Transgender Equality and National Gay and Lesbian Task Force. Retrieved from http://www.thetaskforce.org/downloads/reports/reports/ntds_full.pdf
- Mitchum, P., & Moodies-Mills, A.C. (2014). *Beyond bullying: How hostile school climate perpetuates the school-to-prison pipeline for LGBT youth*. Washington, DC: Center for American Progress. Retrieved from <http://cdn.americanprogress.org/wp-content/uploads/2014/02/BeyondBullying.pdf>
- Irvine, A. (2014). *Dispelling myths: Understanding the incarceration of lesbian, gay, bisexual, and gender nonconforming youth* (unpublished). Oakland, CA: National Council on Crime and Delinquency,.